

# FIXING INSTRUCTIONS



for installing the Neatdek 3  
true level access shower grille  
and frame

(MODEL Nos. NDK 3001, 3002, 3003)

**frames** *into* **solid floors**

04/06

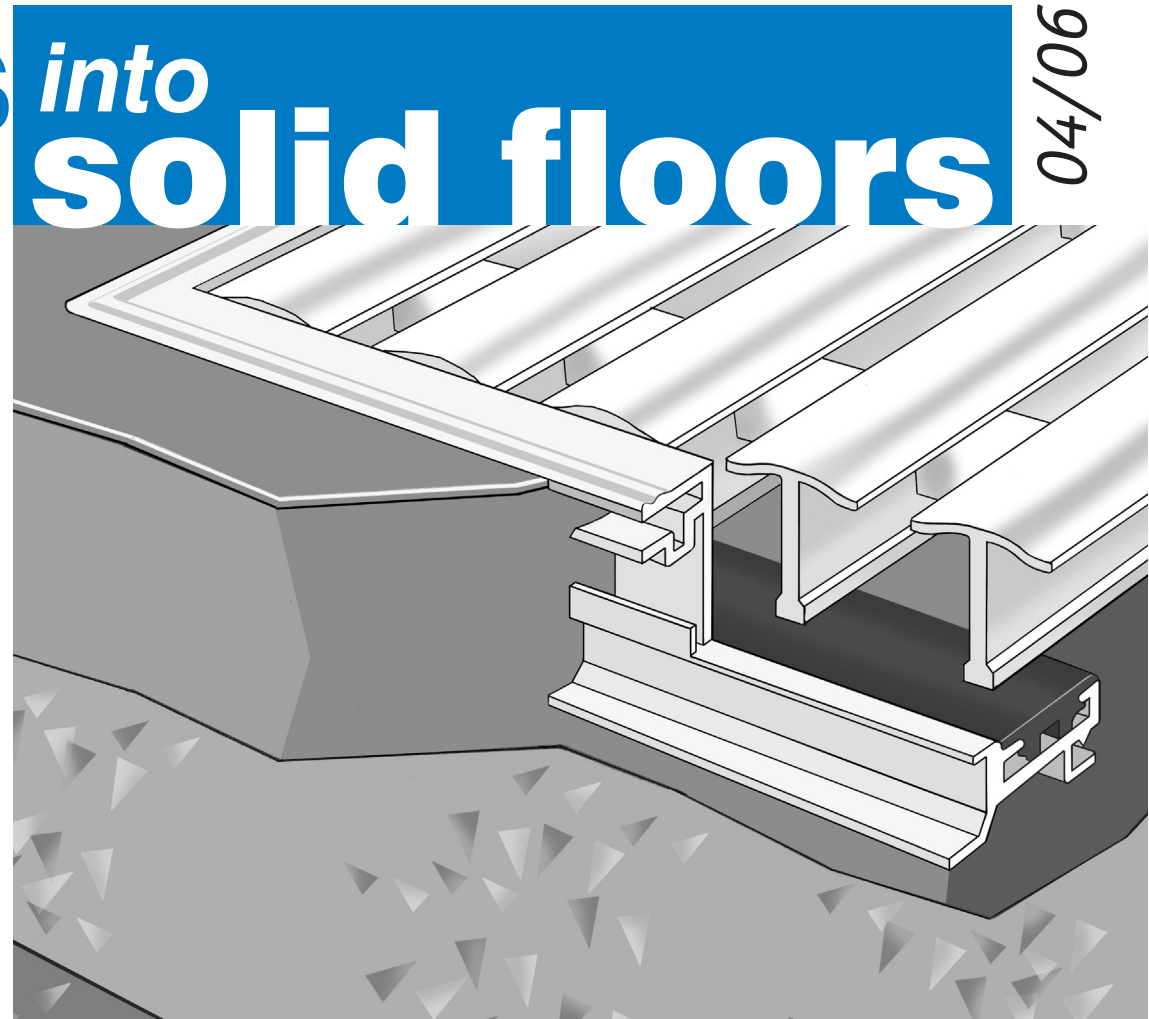

## IF THE SLAB IS 150mm (6") SOLID CONCRETE AND FLOOR SCREED

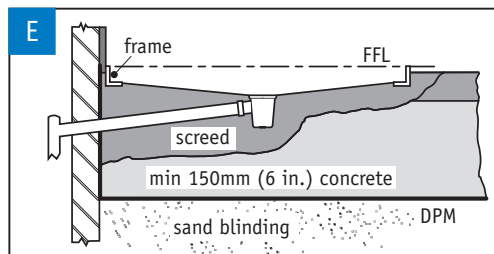
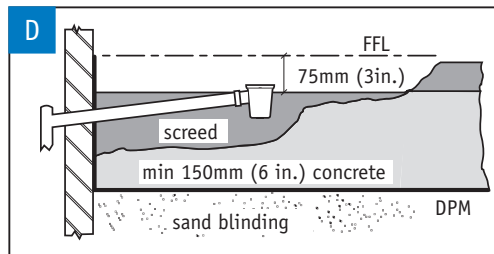
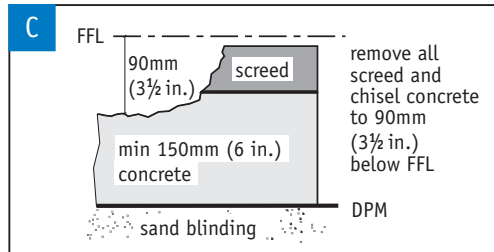

**Note:** Ensure alloy frame and rubber damper is wiped clean of all surplus screed during and at completion of screeding operation, using a soft cloth.

### PREPARING THE AREA

- C**
1. Remove the screed by starting at the pipe chase and working towards the outside mark, always cutting **vertically** into the screed. Then chisel the top of the remaining slab to 90mm below FFL (Finished Floor Level). See diagram C.  
**Note:** Where a wall abuts the shower frame, remove plaster to at least 150mm above FFL, in preparation for rendering during the screeding operation.
  2. Clean all dust and rubbish from the dressed face. Assemble and position the pipe and trap.

### D BEDDING THE FRAME AND SCREEDING TO FALLS

- D**
1. Lightly dampen the concrete and brush with a creamy cement/water grout (not necessary on new concretes - i.e. less than 24 hours old). DO NOT USE A BONDING AGENT, as this may react to the water proofer.
  2. Thoroughly mix a waterproof screed using 2½ parts sharp sand and 1 part cement with Sealcrete double-strength pre-mix at 2½ litres per 50kg of cement to a **very stiff mix**.
  3. Cast trap and waste outlet pipe in position ensuring complete encapsulation of the bottle end of trap and waste outlet pipe. Then screed the remaining area back up to 75mm below FFL. (See diagram D).
- E**
1. Lay a 100mm wide bed of screed all round approximately 32mm below FFL to receive the frame remembering to render the exposed brickwork. (See diagram J on back page). Position the back of the frame one tile and adhesive thickness plus 2mm from the newly rendered walls.
  2. Lightly tap the frame into the bed of screed until it is level at FFL (i.e. slightly proud of floor level to accept the final floor covering). Screed inside the frame to falls (protecting the top of the trap with two or three layers of Clingfilm) and outside the frame to screed level.  
Check that the frame is level and has not moved out of square.
  3. Remove any water from the screed surface e.g. by laying newspapers gently on top to absorb the excess, then smooth the screed. **Note:** the cement can only be trowelled smooth once it has started to harden. Proceed to floor and wall finishing (back page).

# setting and exposing floor slabs

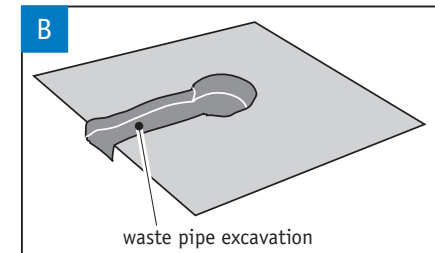
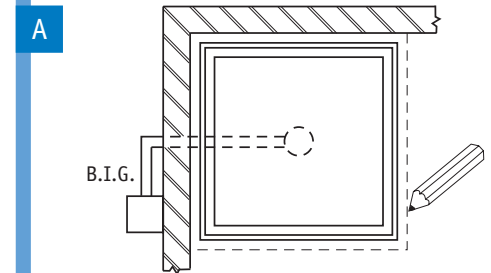

**NEAGO**  
accessibility  
FOR ALL

FOR PUMPED WASTE OUT

# g out the area

## IF THE SLAB IS THIN (LESS THAN 150mm) OR WEAK

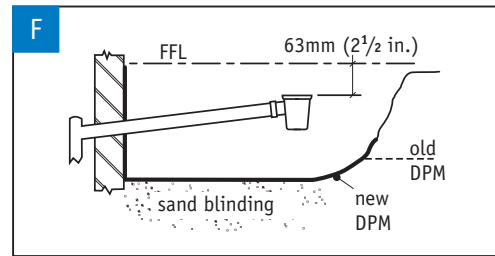

**Note:** Thoroughly mix stone, sand and cement DRY, then add the pre-mix with small amounts of water until the mix is sufficiently wet to bind (no free water).

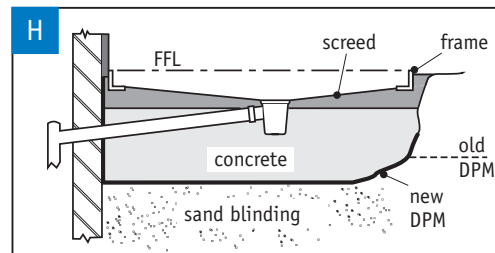
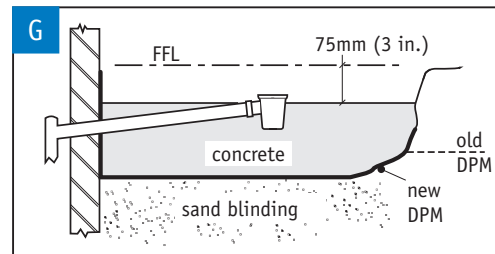

**Note:** Ensure alloy frame and rubber damper is wiped clean of all surplus screed during and at completion of screeding operation, using a soft cloth.

### PREPARING THE AREA

- F
  1. Starting at the pipe chase, break out the entire slab to the marked outside line.
 

**Note:** Where a wall abuts the shower tray, remove plaster to at least 150mm above the FFL, in preparation for rendering during the screeding operation.
  2. Clean the area thoroughly, assemble and position the pipe and trap so that the top of the trap is set 63mm (2½") below FFL. Sand blind the excavation, restore the DPM, and heat retaining insulation.
  3. Clean all dust and rubbish from the cut edge of the concrete and dampen (the new concrete will not bond if dust is not removed before dampening).
  4. Make good with a waterproof concrete using 4 parts ½" stone, 2 parts sharp sand and 1 part cement, adding Sealcrete double-strength premix at 2½ litres per 50kg of cement.
- G
  1. Place the concrete in the excavation and compact (paying particular attention to the edges and ensuring complete encapsulation of the bottle end of trap and waste outlet pipe). Concrete 75mm below FFL.

### BEDDING THE FRAME AND SCREEDING TO FALLS

- H
  1. Lightly dampen the concrete and brush with creamy cement/water grout (not necessary on new concretes - i.e. less than 24 hours old) DO NOT USE A BONDING AGENT, as this may react with the water proofer.
  2. Thoroughly mix a waterproof screed using 2½ parts sharp sand and 1 part cement with Sealcrete double-strength pre-mix at 2½ litres per 50kg of cement to a **very stiff mix**.
  3. Lay a 100mm wide bed of screed all round, approximately 32mm below FFL, to receive the frame remembering to render the exposed brickwork. Position the back of the frame one tile and adhesive thickness plus 2mm from the newly rendered wall. (See diagram J on back page).
  4. Lightly tap the frame into the bed of screed until it is level at FFL (i.e. slightly proud of floor level to accept the final floor covering). Screed inside the frame to falls (protecting the top of the trap with two or three layers of Clingfilm) and outside the frame to screed level. Check that the frame is level and has not moved out of square.
  5. Remove any water from the screed surface e.g. by laying newspapers gently on top to absorb the excess, then smooth the screed. **Note:** the cement can only be trowelled smooth once it has started to harden. Proceed to floor and wall finishes (back page).

- A
  1. Lay the frame on the floor in its approximate finished position and mark 50mm clear all round. Determine the direction of the waste outlet pipe and mark out trap and waste pipe run.
 

**Note:** If doors are to be fitted refer to diagram J for the position of the frame in relation to the finished wall surface.

- B
  2. Remove the frame and stitch drill through the slab to either side of the waste outlet pipe run. Break out the slab for trap and waste outlet pipe so that the top of the trap is approximately 63mm below FFL. Break out the wall as required.

This procedure will reveal the slab construction.

Now proceed to C or F.

# floor & wall finishing

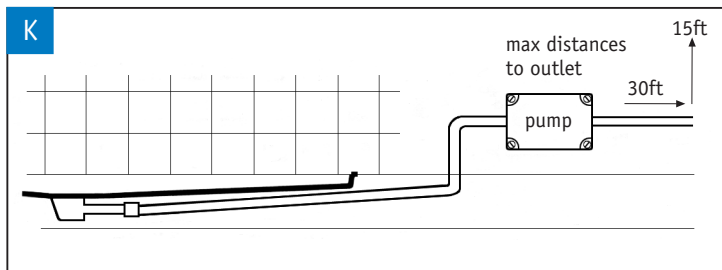
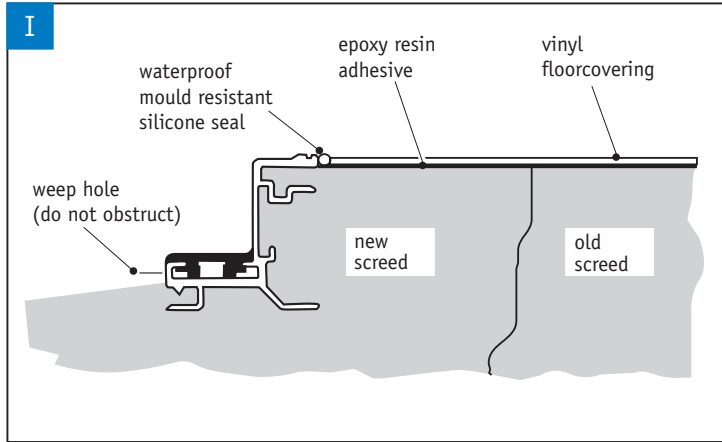

- I**
1. When the screed has dried, lay the selected floor finish according to the manufacturer's instructions. Vinyl floorcoverings must be laid with a waterproof epoxy resin adhesive, ensuring that the floor adjacent to the shower frame is completely covered, with no danger of water seepage at this point.
  2. Finish the joint lines with a mould resistant silicone seal (see diagram I). This procedure will create an impermeable finish.

- J**
1. Tile the walls in the normal manner. To ensure correct door installation the tile face (or finished wall covering) must finish as shown in diagram J.
  2. Position the shower grille within the frame.

- K**
1. Where conventional drainage is not feasible, successful installations can be achieved by incorporating a pump within the outlet system. Specialist advice is always available from our installation engineers.

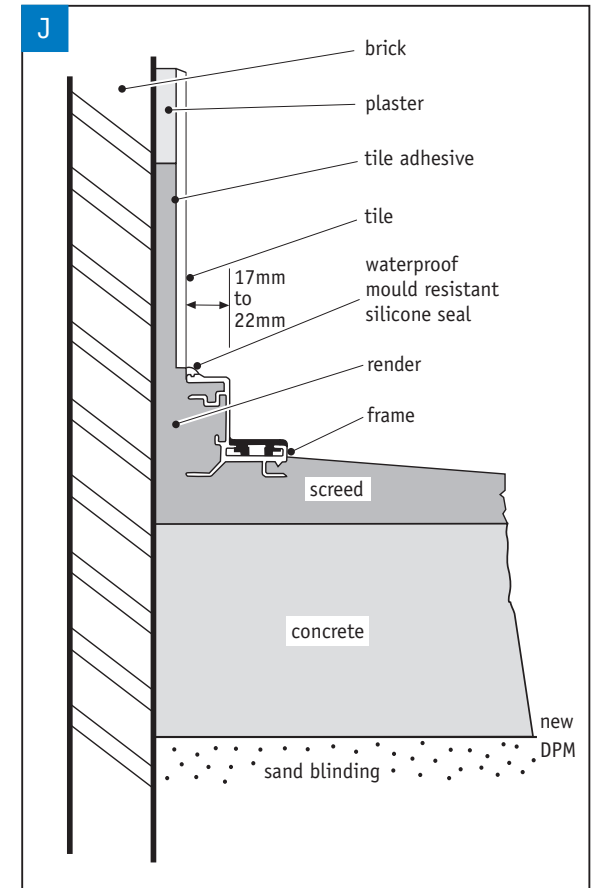

**NEACO**  
*accessibility*  
 FOR ALL

Neaco Ltd, Norton Grove Industrial Estate, Norton, Malton, N. Yorkshire YO17 9HQ  
 Tel: 01653 695721 Fax: 01653 600418 sales@neaco.co.uk www.neaco.co.uk